

ALL PRODUCT DIMENSIONS ARE BEFORE COATING

REFERENCE DRAWING ONLY - NOT TO BE USED FOR INSPECTION PURPOSES

DO NOT SCALE

MATERIAL SPECIFICATION

CENTRE SLEEVE (Part 1)
Ductile Iron to BS EN1563
SYMBOL EN-GJS-450-10
END RINGS (Parts 2 & 4)
Ductile Iron to BS EN1563
SYMBOL EN-GJS-450-10
GASKETS (Parts 3 & 5)
EPDM to BS EN 681-1, TYPE WA, WC
NITRILE to BS EN 681-1, TYPE WA, WC, WG
or BS EN 682, TYPE G
BOLTS (Part 6)
Steel to BS EN ISO 898-1
Property Class 4.8
NUTS (Part 7)
Steel to BS4190
Grade 4
WASHERS (Part 8)
Stainless Steel to BS1449:Part 2
Grade 304S15

FINISH SPECIFICATION

NOTES

BOLT TORQUE

55-65Nm

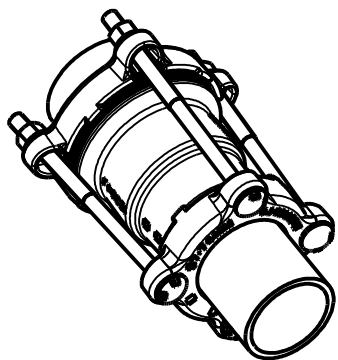

ISOMETRIC VIEW

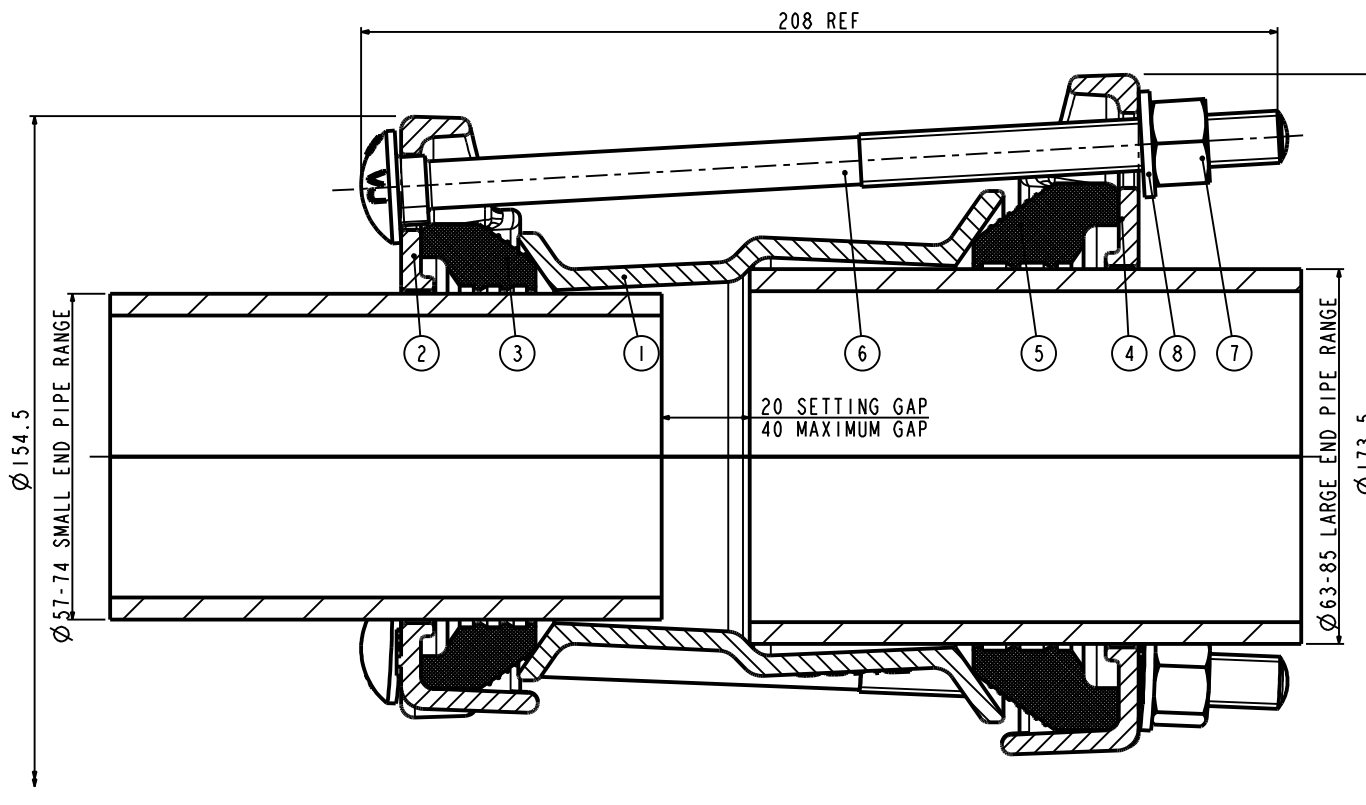

PIPE RANGES				GASKET MOULDS		BOLTS	WORKING PRESSURE	TEST PRESSURE	WEIGHT KG	ASSEMBLY DRG NO
SMALL END		LARGE END		SMALL END	LARGE END					
57	74	63	85	12392_1	12392_2	4-M12x200	16bar	24bar	3.6	12395_1

OVERALL DIMENSIONS DRAWING
FOR REFERENCE ONLY
VIKING JOHNSON RESERVE THE
RIGHT TO AMEND DETAILS WITHOUT
PRIOR NOTIFICATION

This drawing is the exclusive property of VIKING JOHNSON and is confidential and must not be reproduced or disclosed to a third party without written consent. It must be used only for the purpose which it has been issued and is returnable on request.

CRANE A Crane Co Company



OVERALL DIMENSIONS OF
MAXIFIT
STEPPED COUPLINGS
FOR 57-74 TO 85-107MM O.D. PIPE RANGES

RELEASE LEVEL: Released

SHEET 1 OF 1



DRAWN	P. N.	SCALE	1:750
DATE	31-Jan-07	GENERIC	O_DIM_12395_1_1

DRG NO O_DIM_12395_1_1