

# ALL PRODUCT DIMENSIONS ARE BEFORE COATING

REFERENCE DRAWING ONLY - NOT TO BE USED FOR INSPECTION PURPOSES

DO NOT SCALE

## MATERIAL SPECIFICATION

**END RING (Part 1)**  
STEEL to  
BS EN10025-2:2004 GRADE S275JR  
**CENTRE SLEEVE (Part 2)**  
STEEL to  
BS EN10025-2:2004 GRADE S275JR  
**GASKET (Part 3)**  
RUBBER 80 HARDNESS  
Grade to suit service  
**BOLTS (Part 4)**  
STEEL BS EN ISO898-1:1999  
PROPERTY CLASS 4.8  
**NUTS (Part 5)**  
STEEL BS4190:2001  
GRADE 4  
**WASHERS (Part 6)**  
STAINLESS STEEL BS1449:PART 2:1983  
GRADE 304S15

## FINISH SPECIFICATION

## NOTES

Locating Plugs/Pin Register  
If Locating Plugs/Pins are required,  
3 are to be supplied.

## BOLT TORQUES

PIPE MATERIAL	Nm	lbf ft
GRP/GRP	47-60	35-45
GRP/ALL OTHERS	47-60	35-45
ALL OTHERS	95-120	70-90

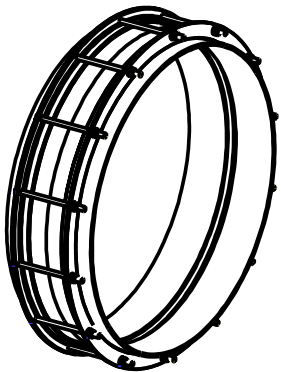

ISOMETRIC VIEW

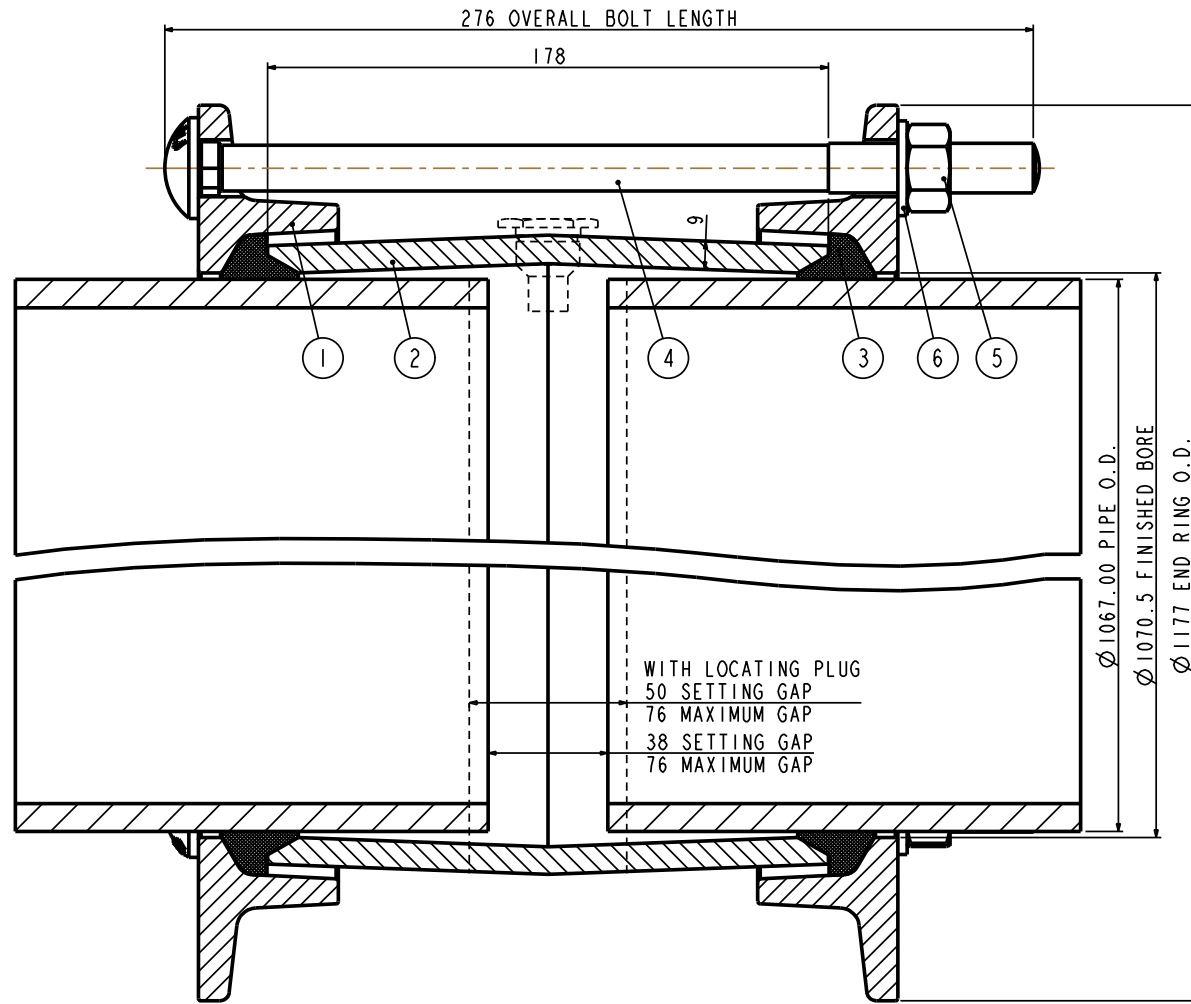

PIPE O.D.	PIPE MATERIAL	PIPE TOLERANCE		BOLTS	GASKET MOULD	WORKING PRESSURE	TEST PRESSURE	WEIGHT KG	ASSEMBLY DRG NO
		+	-						
1067.00	STEEL	1.60	1.60	14-M16x265	J72LS	17.7bar	26.6bar	98.63	7879_14

OVERALL DIMENSIONS DRAWING  
FOR REFERENCE ONLY  
VIKING JOHNSON RESERVE THE  
RIGHT TO AMEND DETAILS WITHOUT  
PRIOR NOTIFICATION

This drawing is the exclusive property of VIKING JOHNSON and is confidential and must not be reproduced or disclosed to a third party without written consent. It must be used only for the purpose which it has been issued and is returnable on request.

**CRANE** A Crane Co Company

OVERALL DIMENSIONS OF  
VIKING JOHNSON COUPLING ASSEMBLY  
'YF2' SECTION  
FOR 1067.00mm O.D. PIPE

RELEASE LEVEL: Manufacture

SHEET 1 OF 1



DRAWN	AUTO	SCALE	1:250
DATE	21/01/10	GENERIC	7879

DRG NO SKP331-1