

# ALL PRODUCT DIMENSIONS ARE BEFORE COATING

REFERENCE DRAWING ONLY - NOT TO BE USED FOR INSPECTION PURPOSES

DO NOT SCALE

## MATERIAL SPECIFICATION

**FLANGE (Part 1)**  
STEEL to  
BS EN10025-2:2004 GRADE S275JR  
**END RING (Part 2)**  
STEEL to  
BS EN10025-2:2004 GRADE S275JR  
**CENTRE SLEEVE (Part 3)**  
STEEL to  
BS EN10025-2:2004 GRADE S275JR  
**GASKET (Part 4)**  
RUBBER 80 HARDNESS  
Grade to suit service  
**STUDS (Part 5)**  
STEEL to  
BS EN ISO898-1:1999 PROPERTY CLASS 4.8  
**NUTS (Part 6)**  
STEEL to  
BS4190:2001 GRADE 4  
**WASHERS (Part 7)**  
STAINLESS STEEL to  
BS1449:PART 2:1983 GRADE 304S15

## FINISH SPECIFICATION

## NOTES

### STUD TORQUES

PIPE MATERIAL	Nm	lbf ft
GRP	47-60	35-45
ALL OTHERS	95-120	70-90

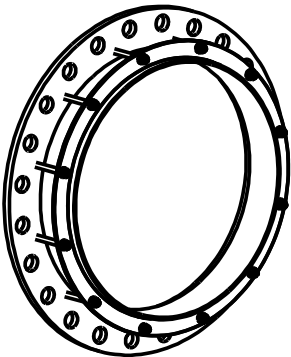

ISOMETRIC VIEW

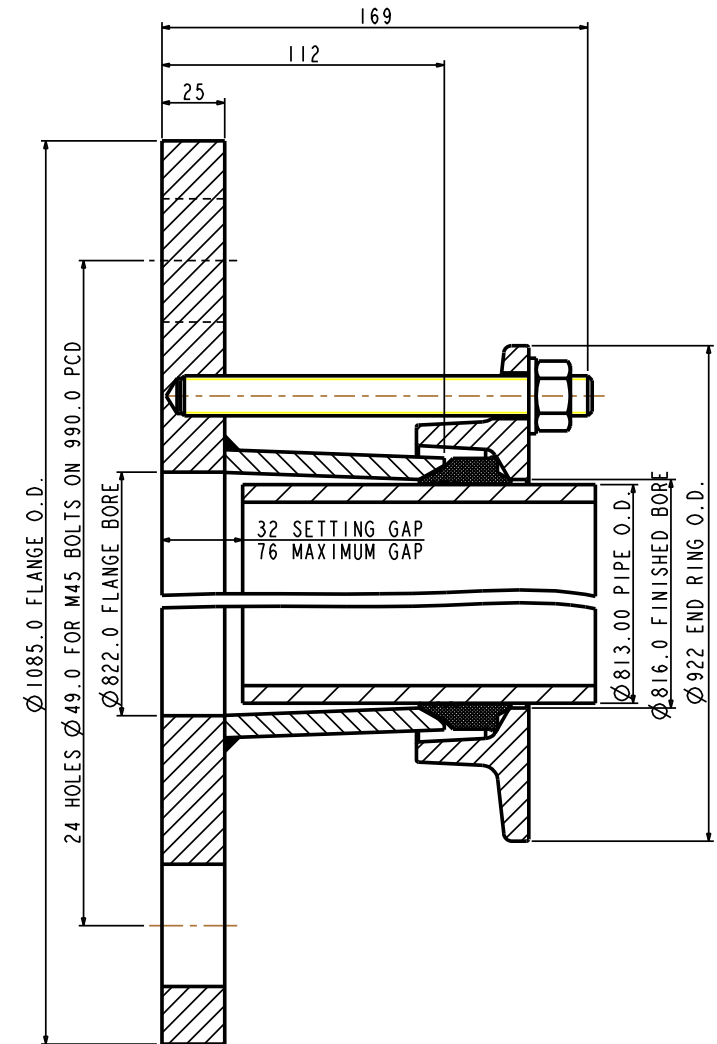
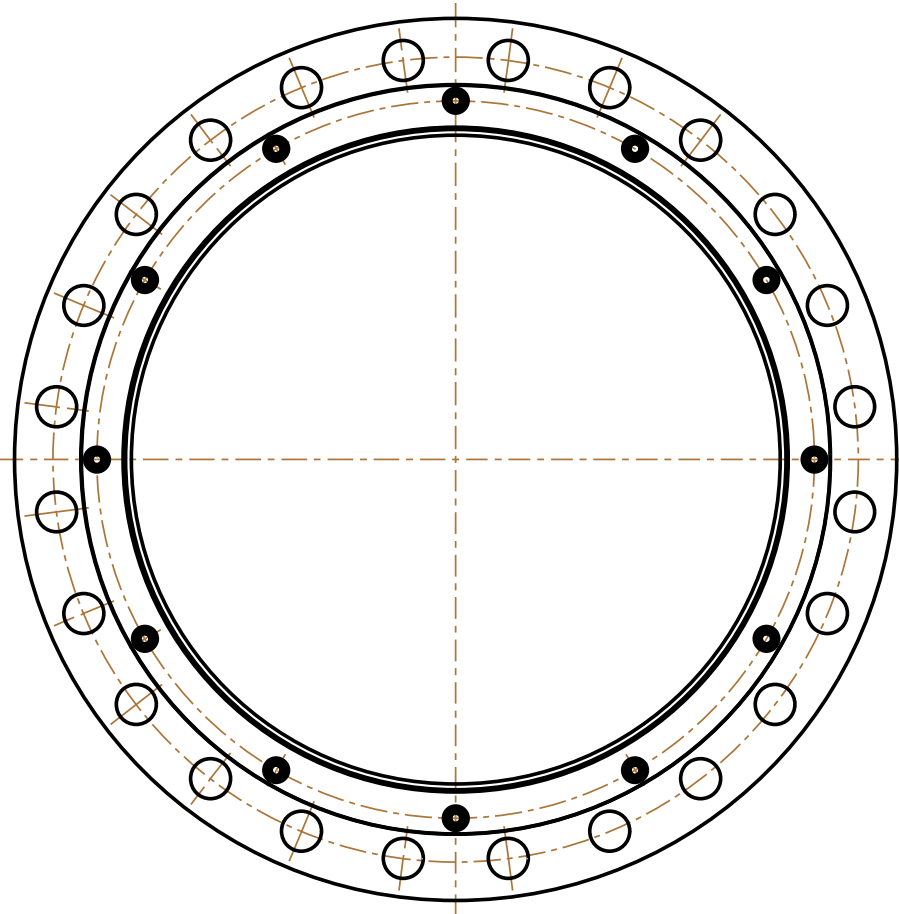

PIPE O.D.	PIPE MATERIAL	PIPE TOLERANCE		FLANGE DRILLING	STUDS NO-SIZE	GASKET MOULD	NO OF NOTCHES	WORKING PRESSURE	TEST PRESSURE	SECTION	WEIGHT KG	ASSEMBLY DRG NO
813.00	STEEL	1.60	1.60	800PN25	12-M16x160	J65LS	NOT REQUIRED	25.0bar	37.5bar	YF2	106.5	7880_27

OVERALL DIMENSIONS DRAWING FOR REFERENCE ONLY  
VIKING JOHNSON RESERVE THE RIGHT TO AMEND DETAILS WITHOUT PRIOR NOTIFICATION

This drawing is the exclusive property of VIKING JOHNSON and is confidential and must not be reproduced or disclosed to a third party without written consent. It must be used only for the purpose which it has been issued and is returnable on request.

CRANE A Crane Co Company

OVERALL DIMENSIONS OF  
VIKING JOHNSON FLANGE ADAPTOR  
YF2 SECTION  
FOR A 813.00mm PIPE O.D.  
WITH A 800PN25 FLANGE DRILLING

RELEASE LEVEL: Manufacture

SHEET 1 OF 1



DRAWN	AUTO	SCALE	0.476
DATE	17/02/09	GENERIC	7880

DRG NO SKP2327-1