

ALL PRODUCT DIMENSIONS ARE BEFORE COATING

REFERENCE DRAWING ONLY - NOT TO BE USED FOR INSPECTION PURPOSES

DO NOT SCALE

MATERIAL SPECIFICATION

FLANGE ADAPTOR ASSEMBLY (Part 1)
FLANGE ADAPTOR (Part 2)
 DUCTILE IRON BS EN1563
 SYMBOL EN-GJS-450-10
END RING (Part 3)
 DUCTILE IRON BS EN1563
 SYMBOL EN-GJS-450-10
GASKET (Part 4)
 RUBBER 80 HARDNESS
 Grade to suit service
TEE-BOLTS (Part 5)
 STEEL to
 BS EN ISO898-1 PROPERTY CLASS 4.8
NUTS (Part 6)
 STEEL to
 BS4190 GRADE 4
WASHERS (Part 7)
 STAINLESS STEEL to
 BS1449:PART 2 GRADE 304S15
SPIGOT PIECE (Part 8)
 DUCTILE IRON BS EN1563
 SYMBOL EN-GJS-450-10
TIE BOLT (Part 9)
 STEEL to
 BS EN10269+A1NAME 42CrMo4
NUTS (Part 10)
 STEEL to
 BS EN20898-2 PROPERTY CLASS 8.0
WASHERS (Part 11)
 STEEL to
 BS EN10269+A1NAME 42CrMo4

FINISH SPECIFICATION

NOTES

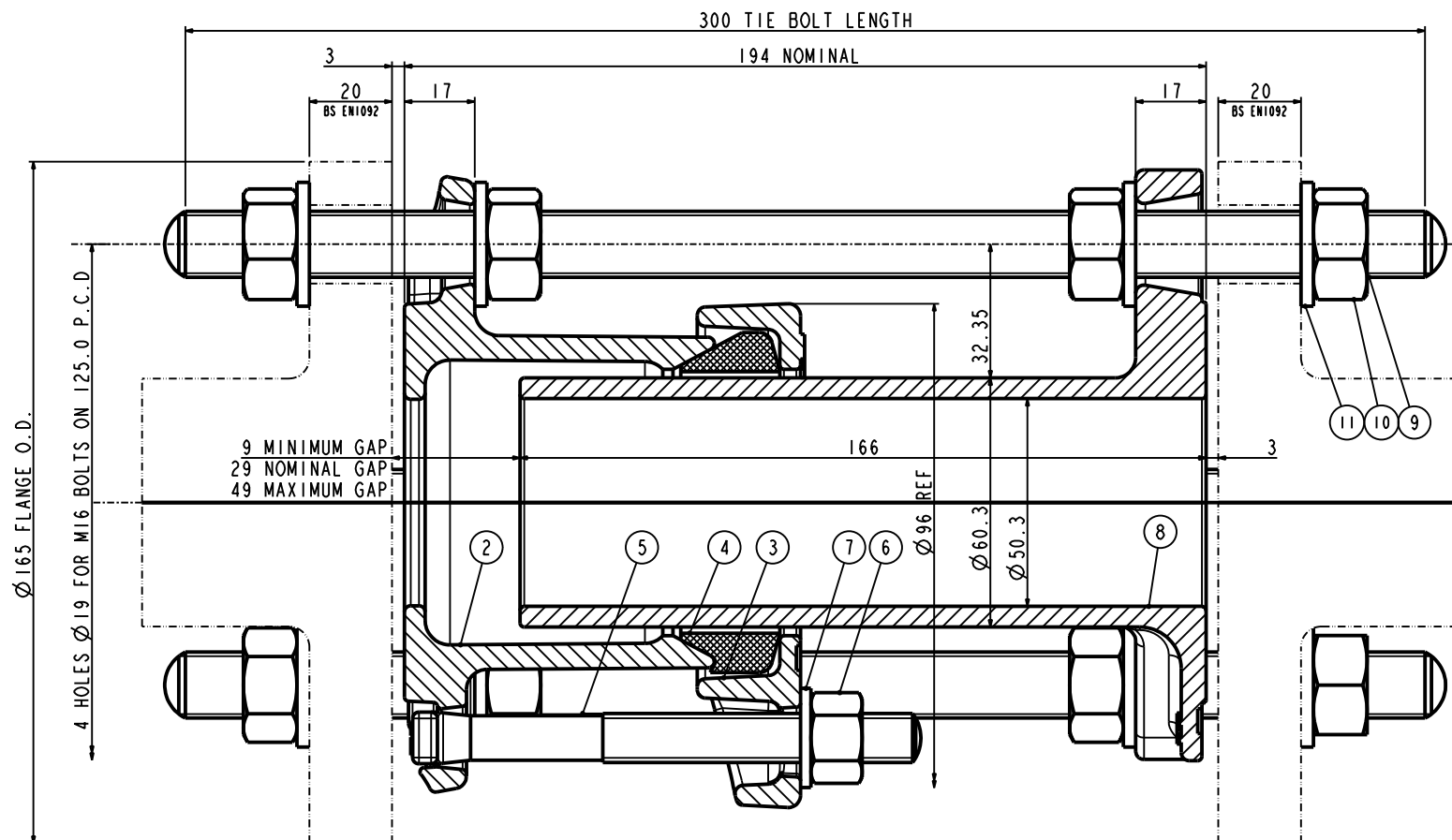

FLANGE DRILLING	WORKING PRESSURE	TEST PRESSURE	GASKET	STUDS NO-SIZE	TIE BOLTS NO-SIZE	WEIGHT Kg	ASSEMBLY DRG NO
50PN10, 16, 25, 40	40.0 bar	60.0 bar	12477-1	2-M12x115	4-M16x300	6.9	10435_394

OVERALL DIMENSIONS DRAWING
 FOR REFERENCE ONLY
 VIKING JOHNSON RESERVE THE
 RIGHT TO AMEND DETAILS WITHOUT
 PRIOR NOTIFICATION

This drawing is the exclusive property of VIKING JOHNSON and
 is confidential and must not be reproduced or disclosed to a third
 party without written consent. It must be used only for the
 purpose which it has been issued and is returnable on request.

CRANE A Crane Co Company



OVERALL DIMENSIONS OF
 DISMANTLING JOINTS ASSEMBLY -QUICKFIT SECTION
 50PN10, 16, 25, 40 FLANGE DRILLING

RELEASE LEVEL: Concept

SHEET 1 OF 1



DRAWN	AUTO	SCALE	0.143
DATE	13-Sep-17	GENERIC	10435.ALL.CAST.001MS.1

DRG NO SKP2392-1

ISOMETRIC VIEW