

ALL PRODUCT DIMENSIONS ARE BEFORE COATING

MATERIAL SPECIFICATION

LINER BODY (Part 1)

Ductile Iron to BS EN1563

Symbol EN-GJS-450-10

CLAMP BANDS (Part 2)

Ductile Iron to BS EN1563

Symbol EN-GJS-450-10

BOLTS (Part 3)

Stainless Steel to BS EN ISO3506-1

Grade A2 Property Class 70

NUTS (Part 4)

Stainless Steel to BS EN ISO3506-2

Grade A4 Property Class 80

WASHERS (Part 5)

Stainless Steel to BS EN ISO3506-1

Grade A2 Property Class 50

O R I N G (P a r t 6)

As specified by order

NOTES

Maximum Working Pressure = 16bar

Maximum Test Pressure = 24bar

Bolt Torque = 200-210Nm

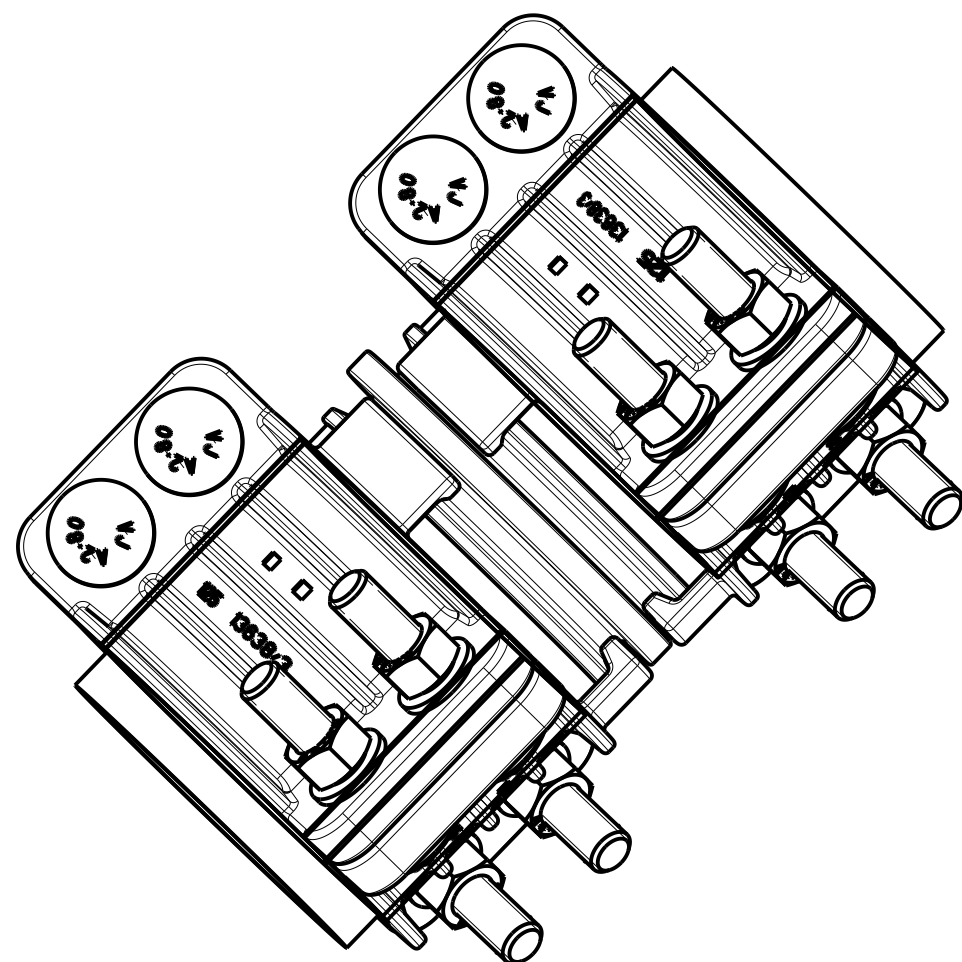

ISOMETRIC VIEW

REFERENCE DRAWING ONLY - NOT TO BE USED FOR INSPECTION PURPOSES.

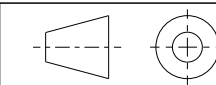

DO NOT SCALE

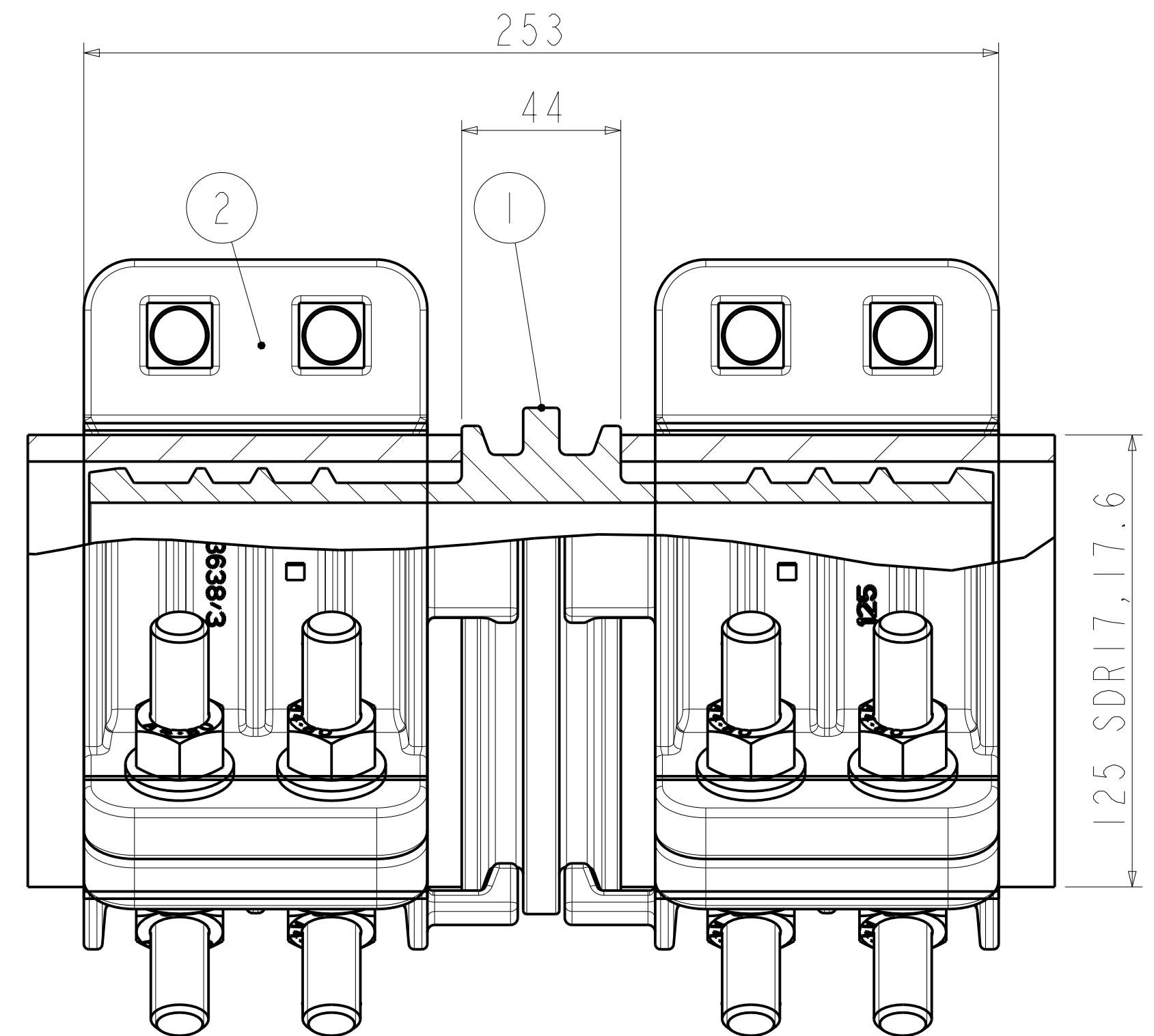
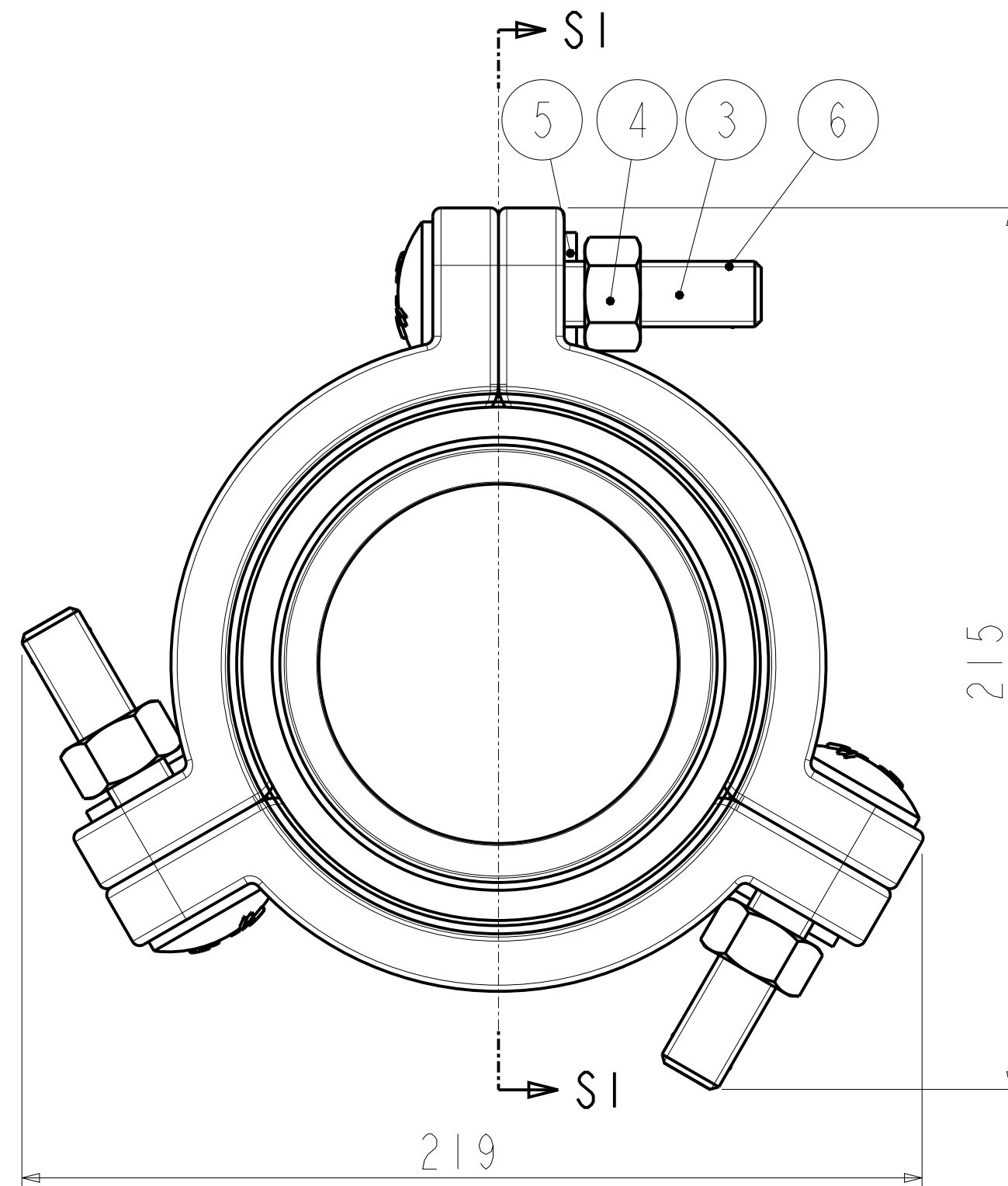

SECTION SI-SI

PIPE OD SDR RATING	BOLT NO-DIAxLENGTH	WEIGHT Kg	ASSEMBLY DRG NO
125 SDR17, 17.6	12-M16x80	17.1	13642_4

OVERALL DIMENSION DRAWING
FOR REFERENCE ONLY
VIKING JOHNSON RESERVE THE
RIGHT TO AMEND DETAILS WITHOUT
PRIOR NOTIFICATION

This drawing is the exclusive property of VIKING JOHNSON and is confidential and must not be reproduced or disclosed to a third party without written consent. It must be used only for the purpose which it has been issued and is returnable on request.

OVERALL DIMENSIONS OF AQUASHIELD COUPLINGS FOR 125 SDR17, 17.6

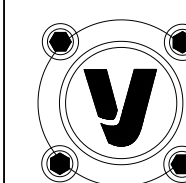

VIKING JOHNSON

World leaders in pipe joints and repair products

DRAWN	AUTO	SCALE	1.000
DATE	May-04-23	GENERIC	O_DIM_13642-4

DRG NO 0_DIM_13642_4_2

CRANE A Crane Co Company

©

RELEASE LEVEL: Released

SHEET 1 OF 1